

ATIS 126.65
 D-ATIS 131.45
 TWR 118.25(118.85)
 GND 121.65
 DCL 131.45

ZYTL DALIAN/Zhoushuizi

N38° 58.0'E121° 32.4' ELEV 33m

AERODROME CHART

| RWY | Direction | Bearing strength(PCN) | |
|-----|-----------|--|------------|
| 10 | 103° | RWY,TWY A1, B, C, D, E, A(connect with RWY) | 68/F/B/W/T |
| 28 | 283° | Stands Nr.17-22 | 68/R/B/W/T |
| | | main TWYA,stands Nr.9-16 | 61/R/B/W/T |
| | | Stands Nr.23-31 | 58/R/B/W/T |
| | | East apron, stands Nr.1-8 | 49/R/B/W/T |

BEARINGS ARE MAGNETIC
 ALTITUDES, DISTANCES,
 ELEVATIONS AND HEIGHTS
 IN METERS

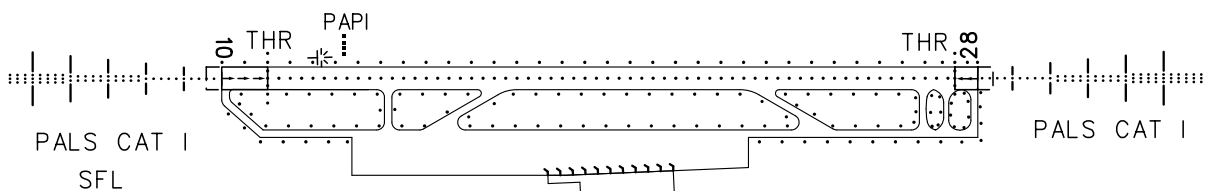
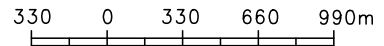
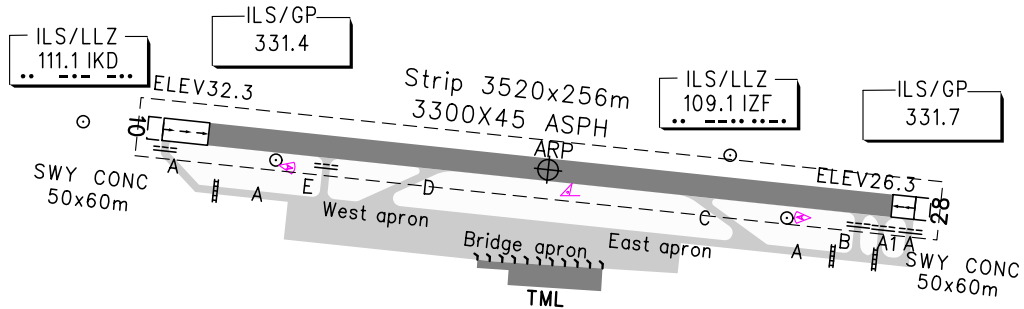

Remarks:

THR RWY10 displaced 200m inwards
 THR RWY28 displaced 100m inwards

Displaced THR

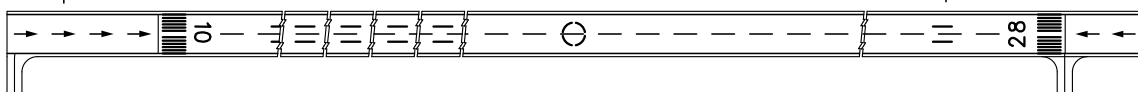

| TAKE-OFF MINIMA(WITH RELIABLE ALTN)(m) | | | | LIGHTS | |
|--|---------------------|----------------------|------------------------|--|----------------------------|
| RWY 10/28 | With REDL & RCLL | With REDL or RCLL | Without REDL & RCLL | RWY10 | RWY28 |
| 2 ENG | RVR500 | RVR600 | VIS1600 | PALS CAT I REDL SFL RCLL PAPI | PALS CAT I REDL RCLL |
| 3&4 ENG | RVR500 | RVR600 | VIS800 | | |

Changes: Sites of RVR and SFC wind sensors.