

ERFURT-WEIMAR
RWY 28

ATIS 133.450 MÜNCHEN RADAR 126.175
GROUND 121.750
TOWER 121.150

TRANSITION
ALTITUDE 5000
VAR 2° E

GPS / FMS RNAV DEPARTURE
CHART - INSTRUMENT
(OVERLAY)

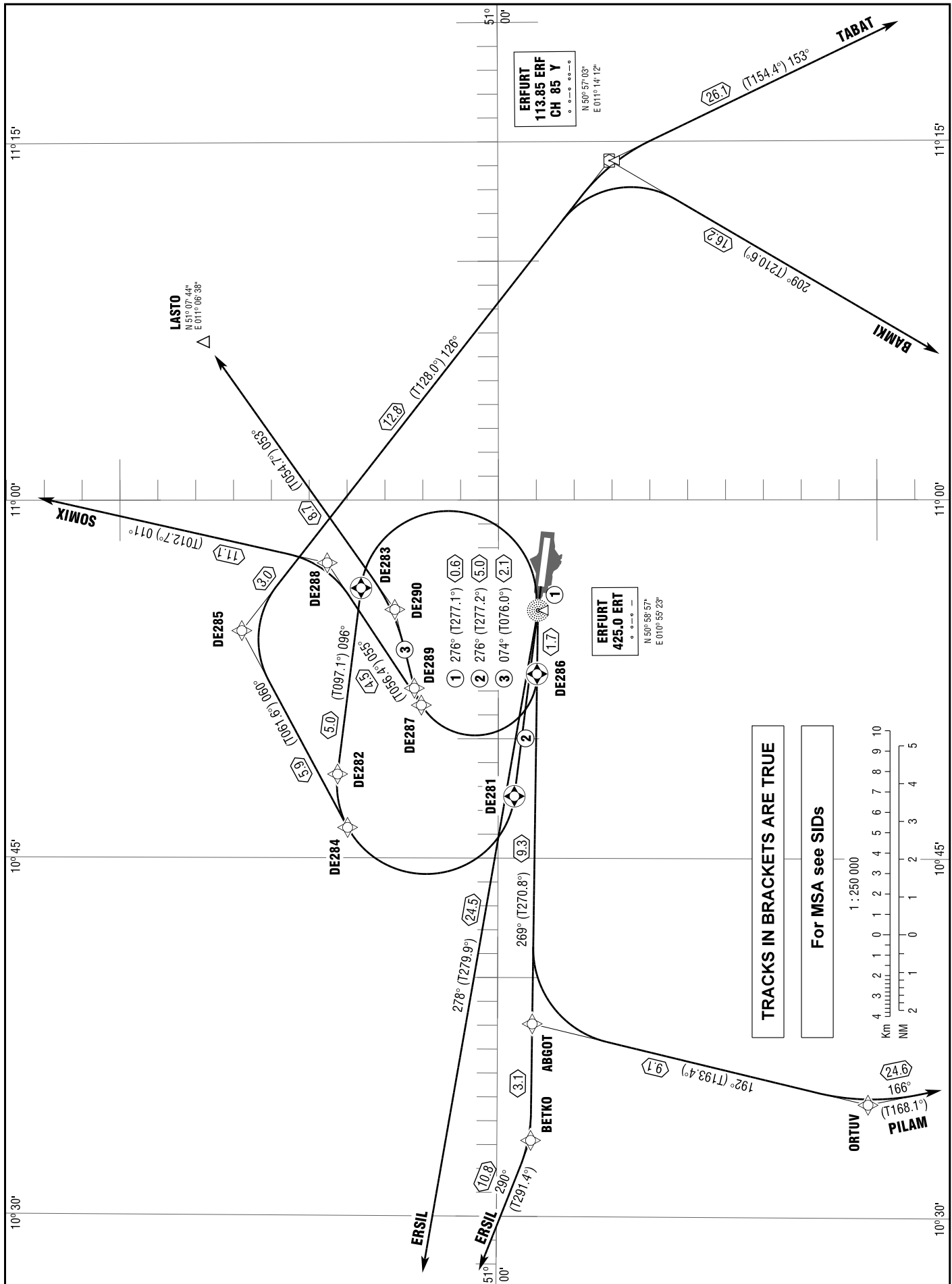

TRACKS IN BRACKETS ARE TRUE

For MSA see SIDs

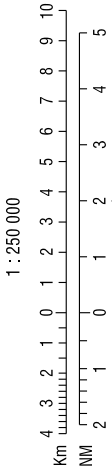

Correction: AD name.